

Glidermatic GTS & Glidermatic GTS Optima Manual Operation Guide

The following instructions demonstrate how to switch your Glidermatic GTS or Glidermatic GTS Optima operator into manual operation mode and then back into automatic operation. This can be particularly useful in the event of a power outage or a problem arising with your operator, allowing you to remove a trapped vehicle from your garage. Please note, you will likely need two people to complete this process and whilst your operator may not look identical to those illustrated, the process is the same for all units.



How to put in Manual Operation Mode:

To put the door into manual operation, pull down firmly on the red ball hanging from your operator whilst simultaneously lifting your door slightly.

Your door can now be manually raised so that any trapped vehicles can be removed.

How to put in Auto Operation Mode:

To put the door into auto operation, simply lower the door to its original closed position. You will hear the Manual Release pin click back into place.

Should the Manual Release pin not re-engage, raise/lower the door manually to the halfway position and press & hold the button on your Gliderol remote until the chain re-engages.

Your door can now be automatically operated.

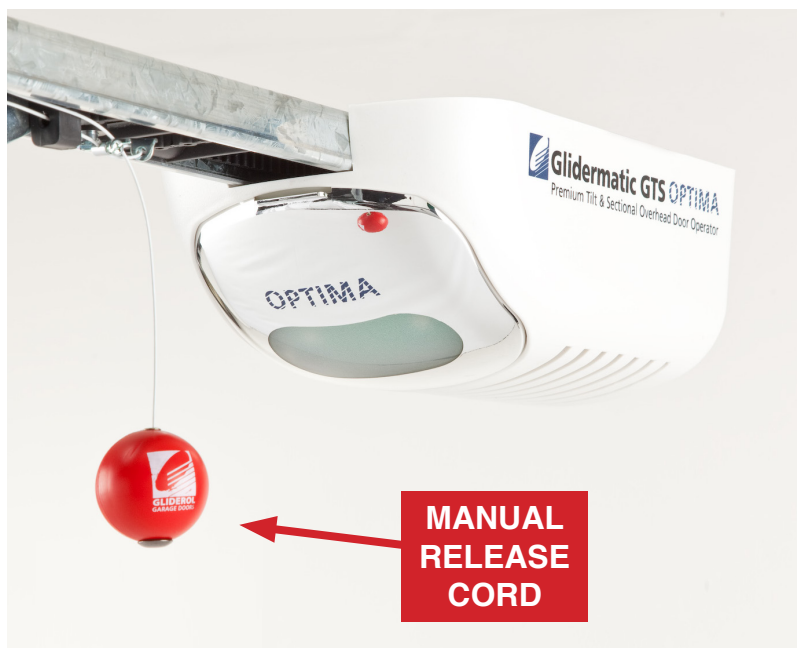

Should you require further assistance in operating your door, please contact your local Gliderol office on 1300 799 177.